

***USER
MANUAL***

***OU-2001
OPHTHALMIC
REFRACTION
UNIT***

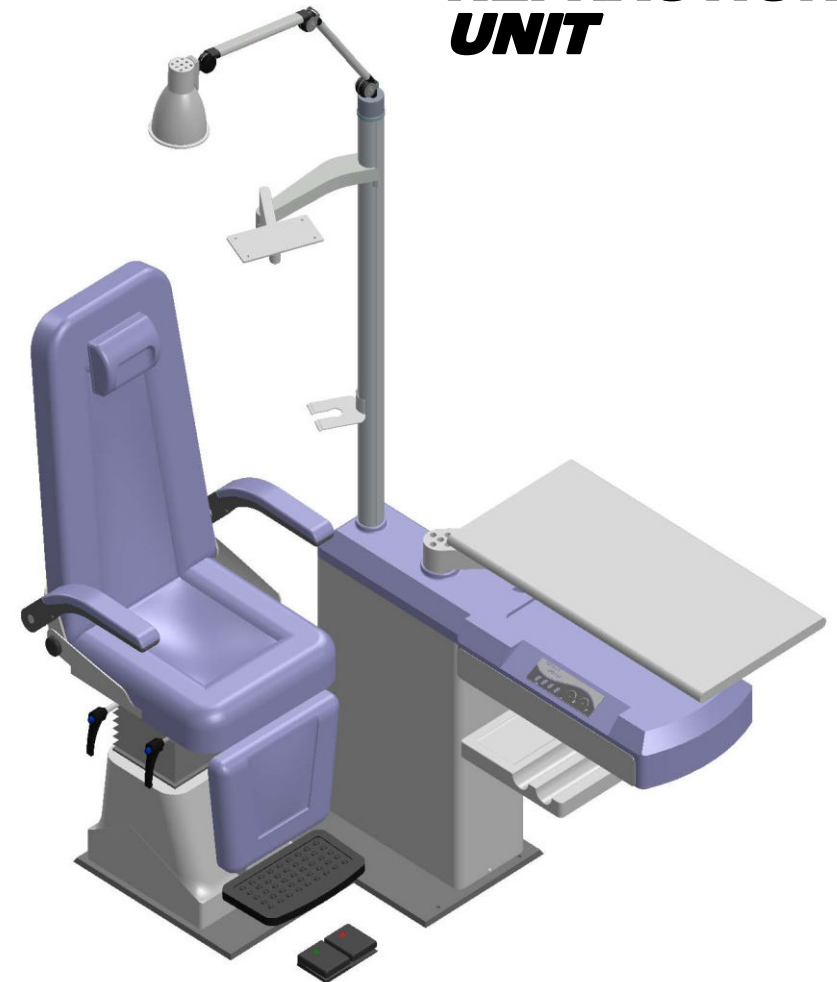

***NEOTECH
MEDICAL
PVT. LTD.***

OU-2001 OPHTHALMIC REFRACTION UNIT

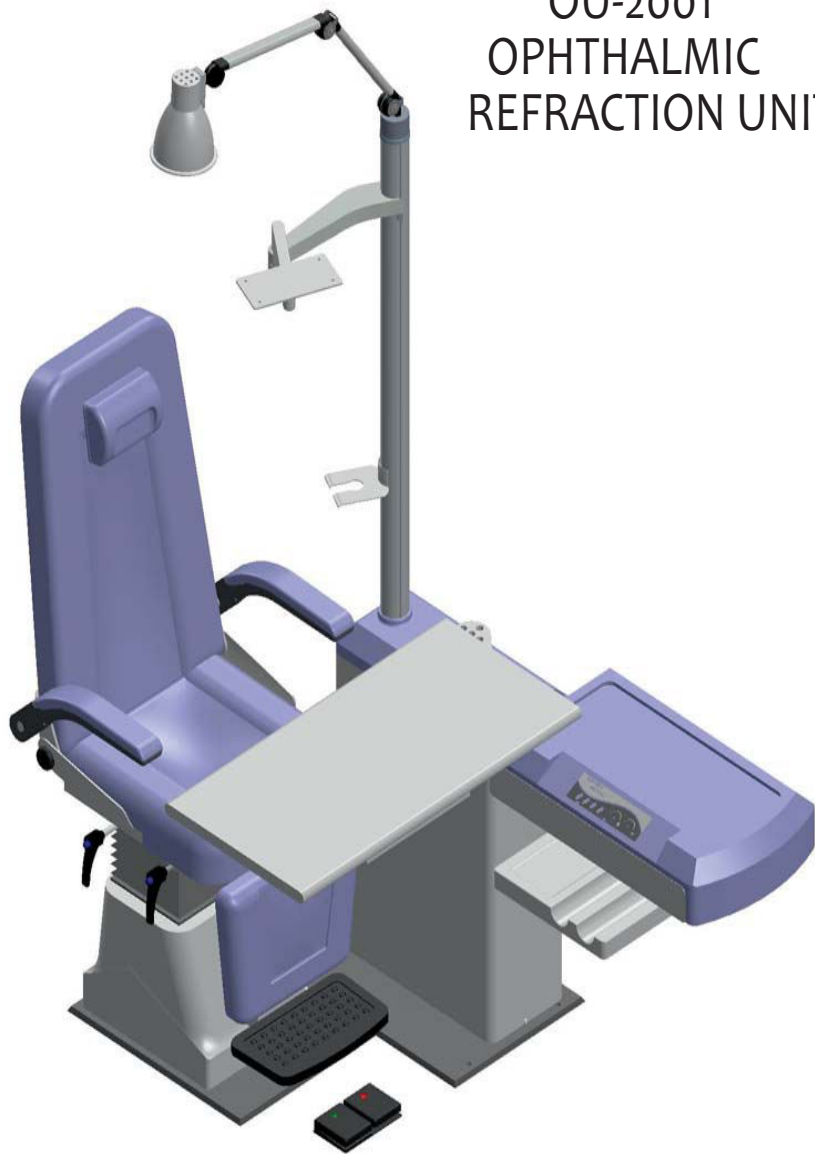

2

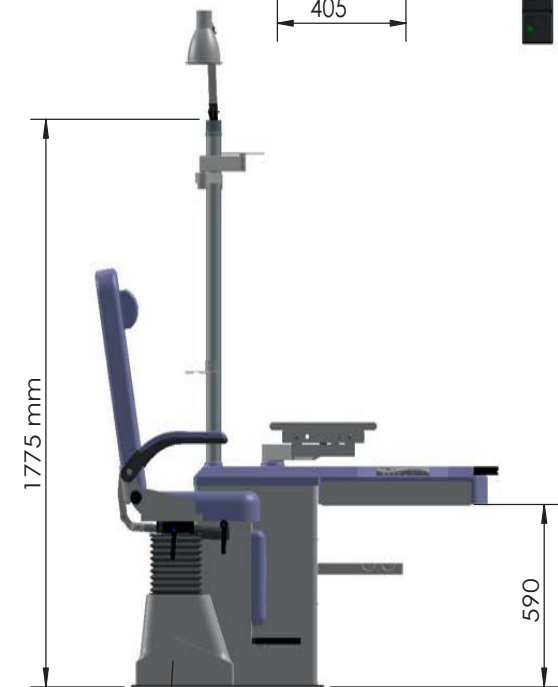
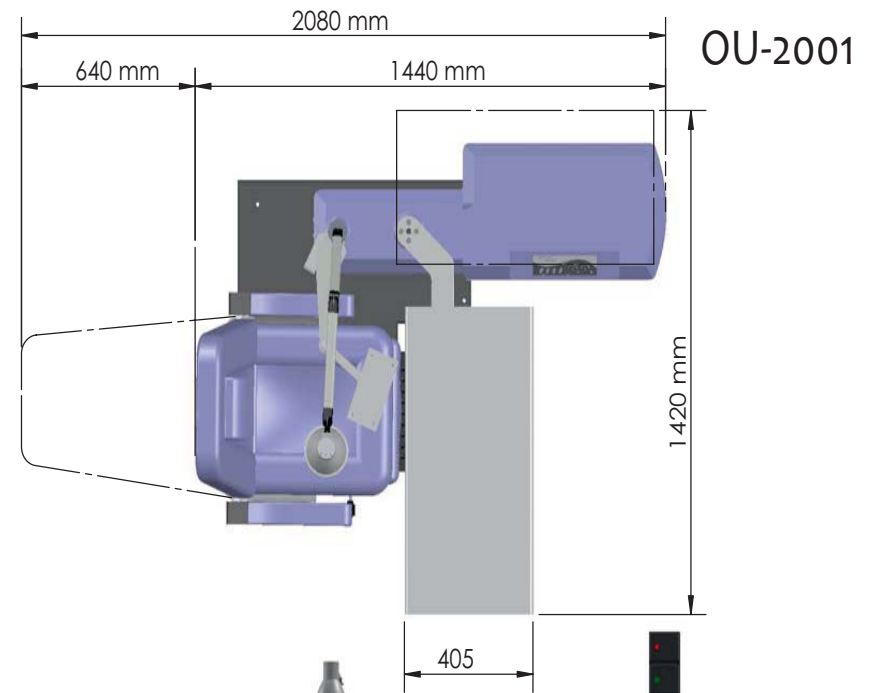

15

HOW TO SOLVE MINOR PROBLEMS YOURSELF

- Check whether there is current in the mains outlet.
- Check whether fuses are intact or should be replaced in case of blown off fuse/fuses make sure their mains cord is pulled out off main 230V plug & insert the fuse/fuses of capacity indicated on the panel.
- For smooth and sleek working of equipments. 2KVA stabilizer is advisable.
- In case reclining function is malfunctioning check both the limit switches fitted underneath of the sitting base.
- Check the connectors connecting backrest moto wiring.
- In case problem persists in the chair's upward/downwards movement check the micro switch fitted underneath the edge of sliding table covered with a thin metal plate while raising the chair upwards the thighs of patient when touches the metal plate the chair's raising action stop if metal plate and micro switch up de stucjk will bring chair in to normal working
- Open the chair raising sysing systemas cover and check that limit switches are in working conition

PREFACE

- We walcome You and thank you for your purchasing NEOTECH Refraction unit
- We would request you to please go through the manual details minutely before proceeding to installation.
- This manual mauy please be preserved and kept at a handy place for reference in future

FEATURE OF CHAIR

- Rotating (up to 180 degrees) chair placed on a reinforced solid base with scratch-resistant plasti-moulded cover , equipped with smooth , salient Electromechanical motor systems for up/down & backward forward movement and commended from the main console panel on the side of the backrest
- Conveniently place foot switch with up/down movement control , enabling the doctor to adjust the patient's sitting height as per individual requirement.
- Optimal inclination high load-lifting capacity at minimum power consumption, Electromechanical Reducer commanded from the main panel.
- Iron laminated unit chassis with frontal access to the controls. Full fledged electronic control system, multi directional movement through the drive motor ,integrated headrest

FEATURE OF UNIT

- Specially designed broad based unit for sturdy stable performance for many years. enables well balanced mounting or equipment and jerk free performance.
- Closed type trial lens drawer to protect lenses from dust contamination Smooth sliding table top that can accommodate two instruments, with automatic connection for slit lamp underneath. and mechanical breaking facility fully activated rheostat controlled overhead task light.
- Integrated control console with easy to use, electronically touchstone keys.
- sturdy pole supporting the lamp phoropter near vision holder and projector arms with height and position manoeuvrability.
- Touch activated safety switch under the table top to stop inadvertent upward movement of the chair elegant single piece moulded console panel that enables centralized control of the whole unit built in connectivity for indirect ophthalmoscope near vision holder and projector instrument holder tray to keep hand help equipment.

GENERAL PRECAUTION

- The refraction unit should be installed at selected spot location free from moisture direct sunlight dust and sea breeze containing salt or sulphur.
- The refraction unit should be installed on evenly leveled surface which should not be subject to vibrations
- Before using the unit ensure that all electrical cords are properly connected and that the unit is otherwise safe to use and also be careful to watch continuously the overall unit and also the patient to insure that nothing is amiss if any thing is found wrong switch off the unit to prevent the patient from being exposed to danger.
- While unplugging the supply . never pull it from the mains cord but from the 3 pin of the cord otherwise it may result in damage to internal connections .
- Unit must be kept neat and clean before and after use if the unit has not been used for some time make sure that it operates properly and safely before using it
- If the unit malfunctions, please refer to the instructions given in the manual under how to solve your minor problems yourself before calling for service

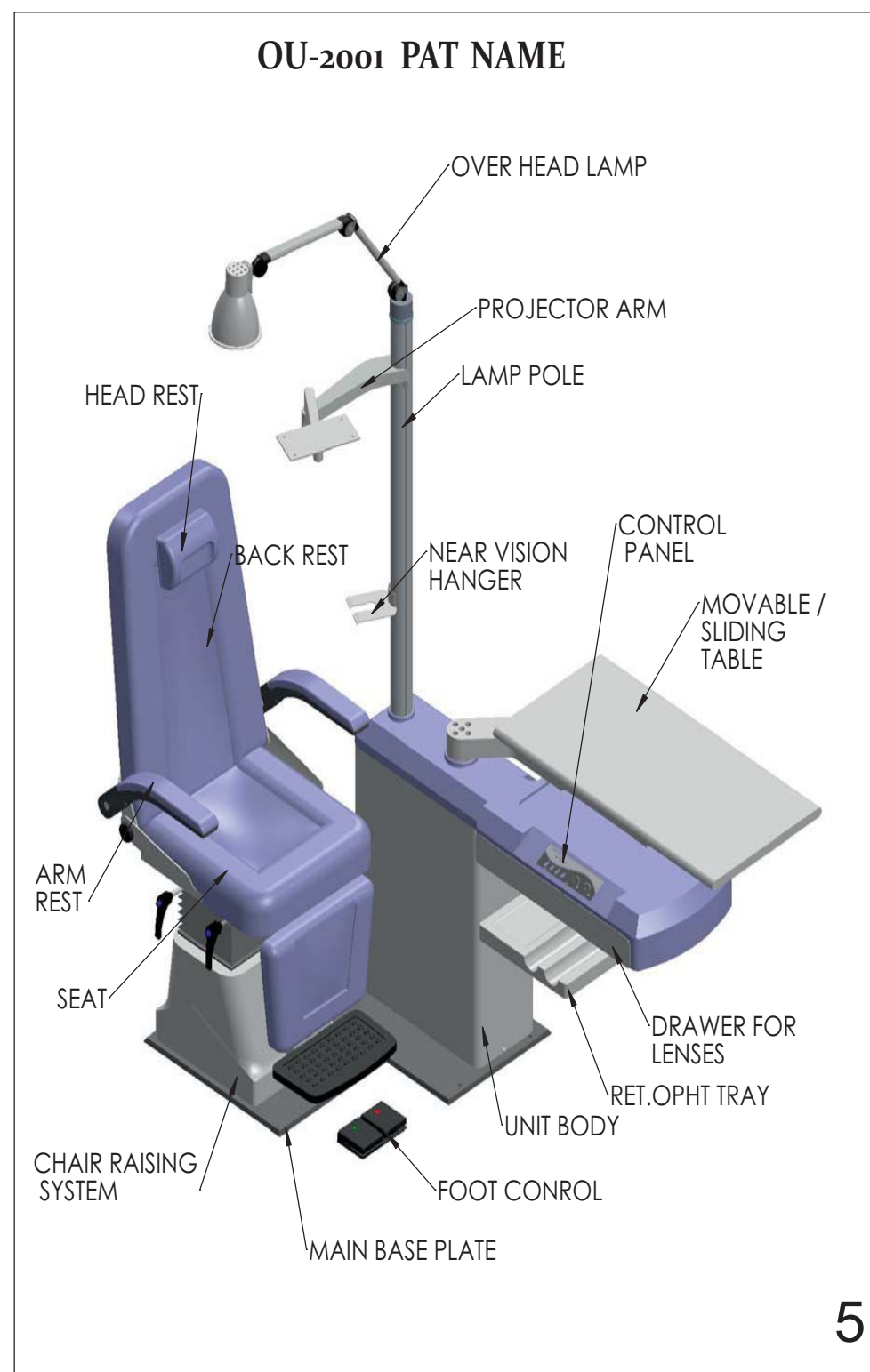
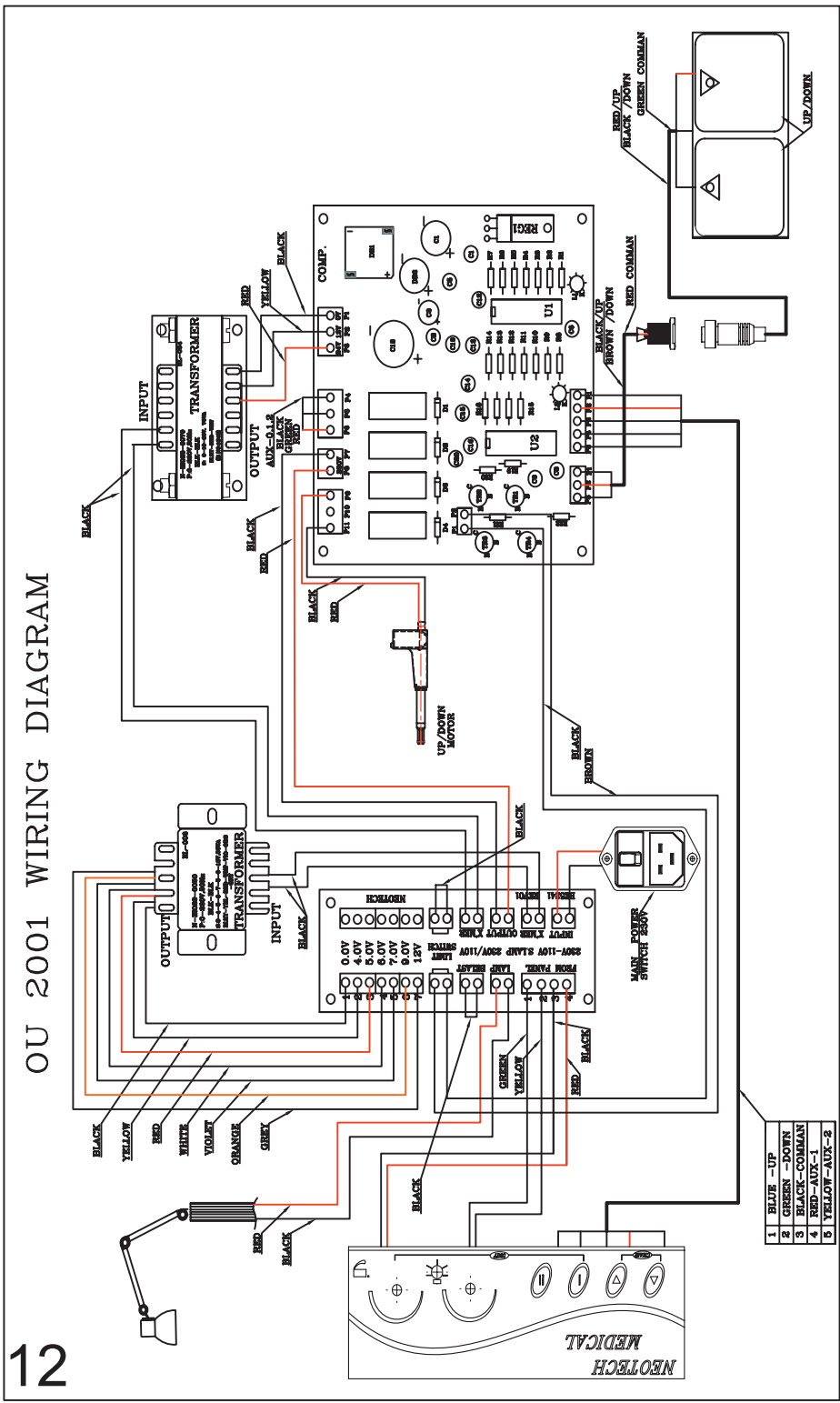

CHAIR ASSEMBLY

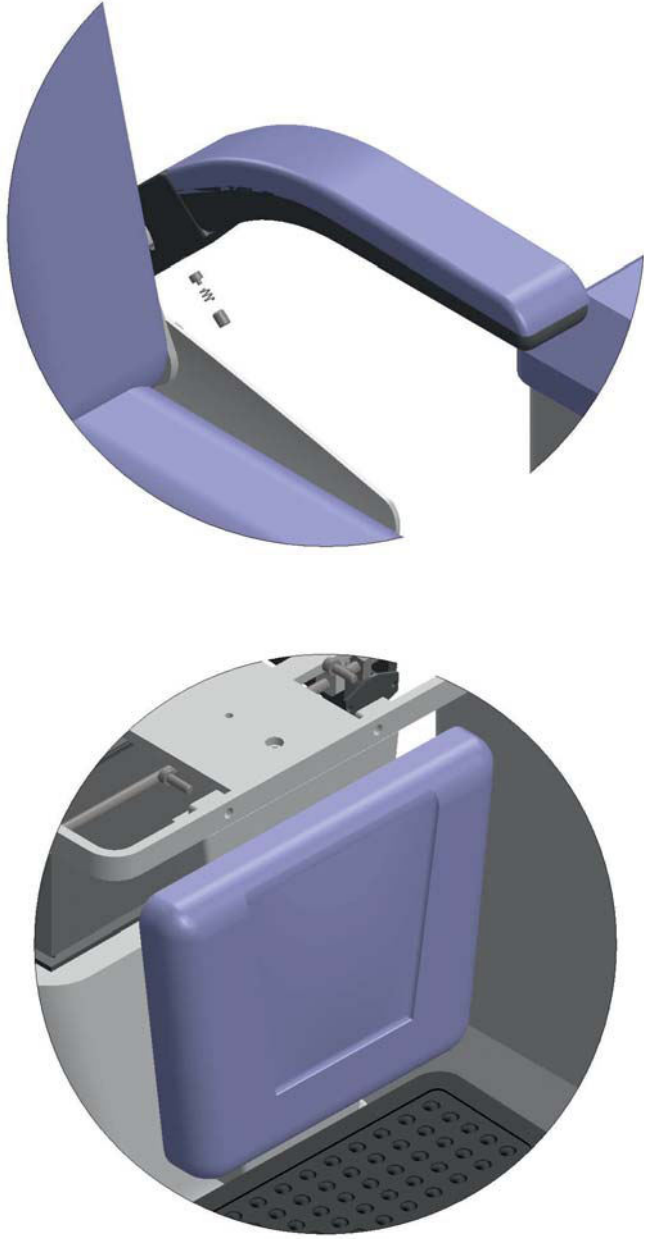

TECH PCB OU-2001

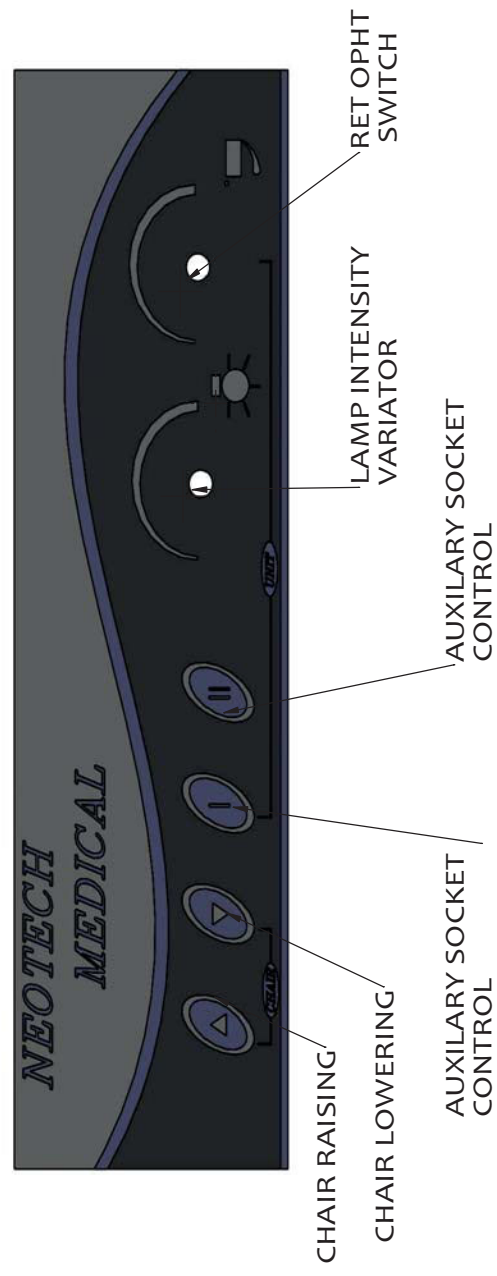

LAMP ASSEMBLY

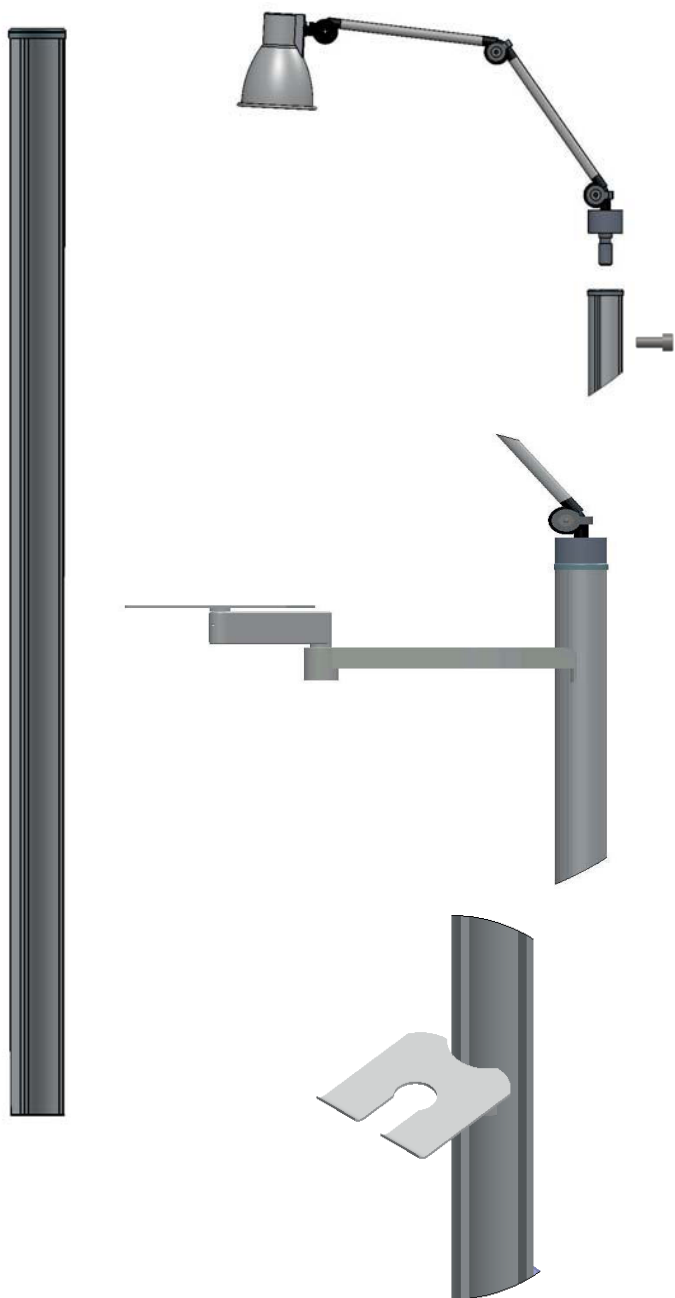

10

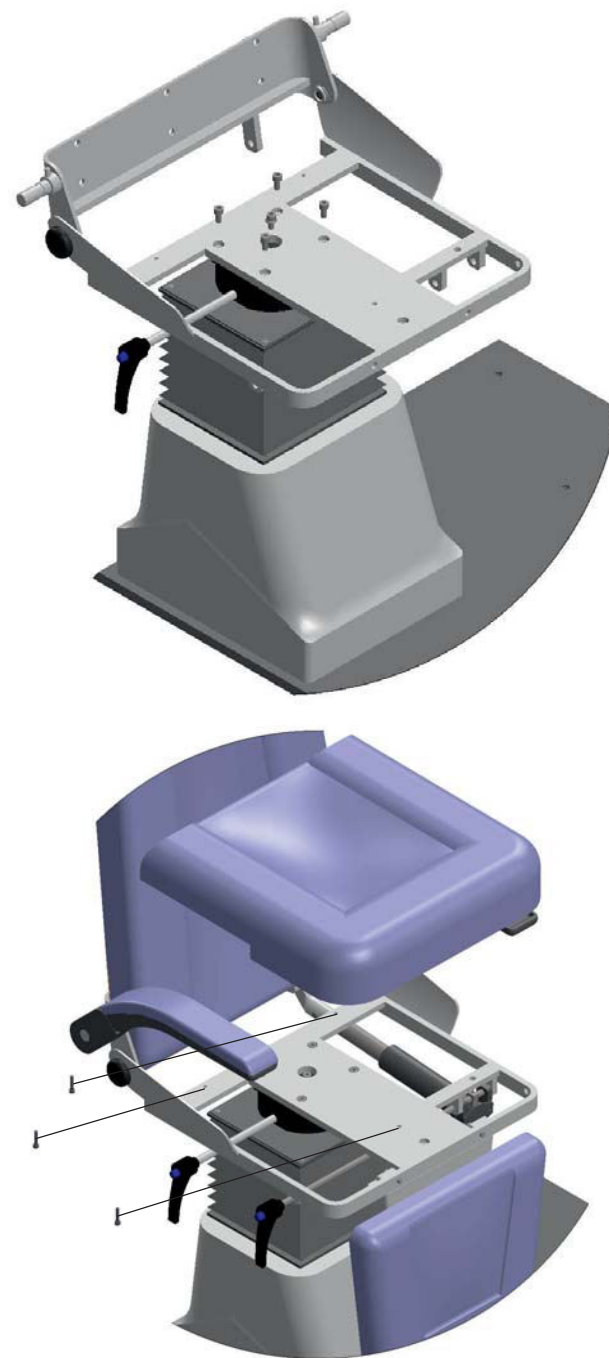

7

UNIT ASSEMBLY

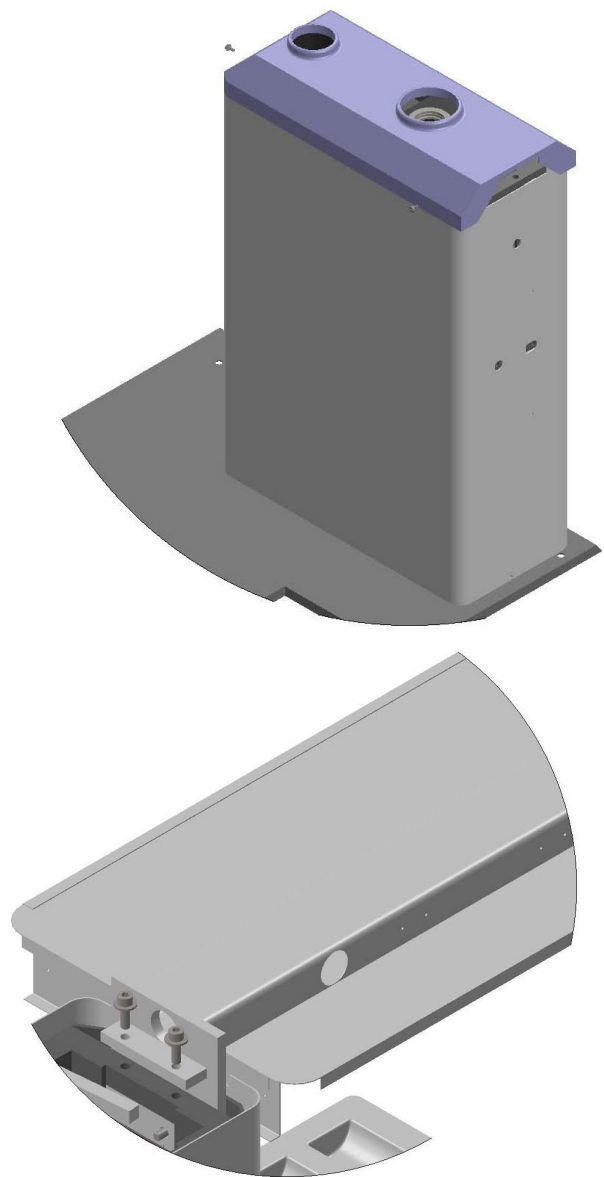

8

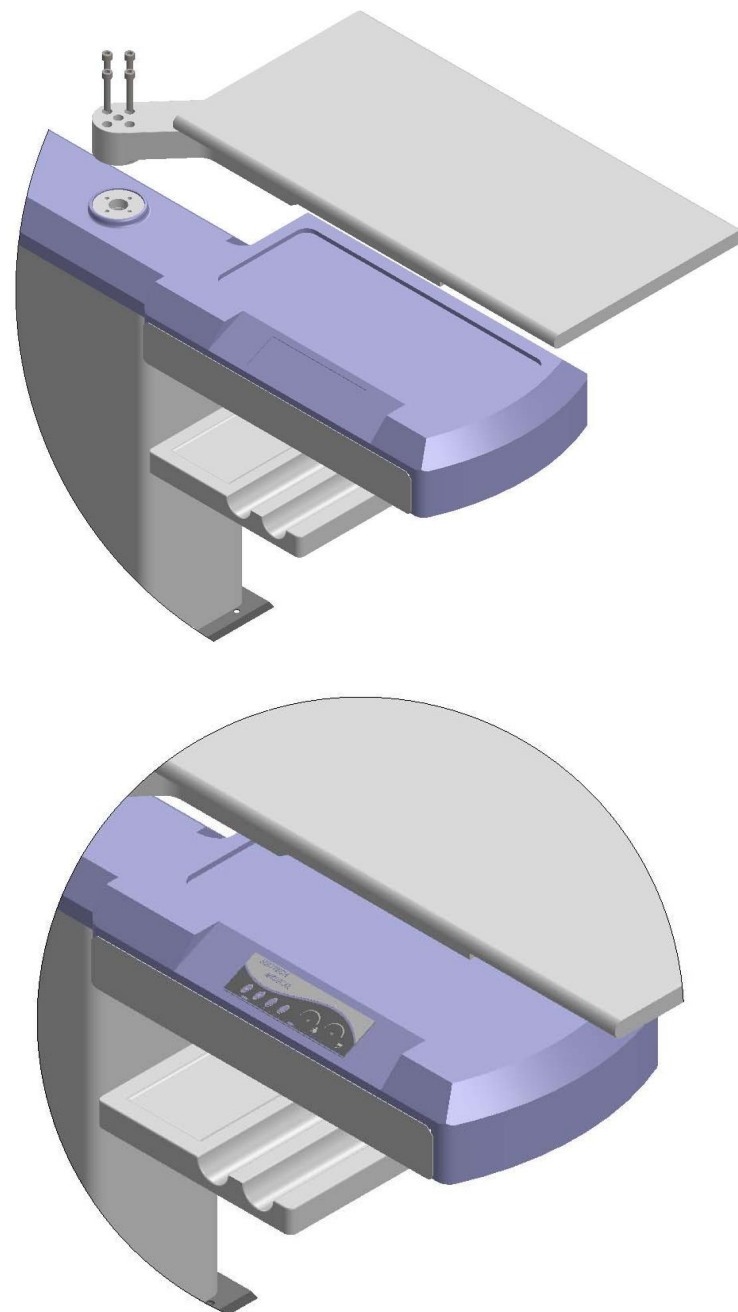

9